



NESPRESSO®

DESCALING
GUIDE





IMPORTANT INFORMATION BEFORE YOU BEGIN

Nespresso recommends descaling every 3 months or 300 capsules (whichever comes first).

Nespresso machines should be descaled with a *Nespresso* Descaling Kit which contains a natural solution that thoroughly dissolves the scale build up. Other solutions (such as vinegar or store-bought descalers) may cause damage to your *Nespresso* machine.

Descaling solution can damage or discolor surfaces so we suggest placing something underneath your machine in case a spill should occur. If a spill does occur, please make sure the solution immediately to avoid any damage.

Keep descaling solution out of reach of children.

In case of contact with eyes, rinse immediately with plenty of water for 15 minutes and seek medical advice.

Do not swallow or ingest the descaling solution.

The descaling solution may be irritating to the eyes and skin.

Avoid filling up the water tank during the descaling process.

After descaling, wipe down the machine with a damp cloth.



LATTISSIMA TOUCH



Duration: 30 minutes

STEP 1

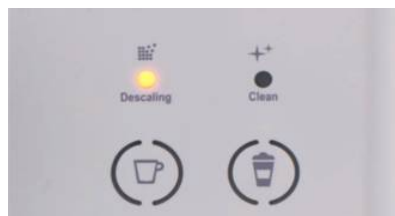

When the descaling alert shines orange, it is time to descale.

STEP 2

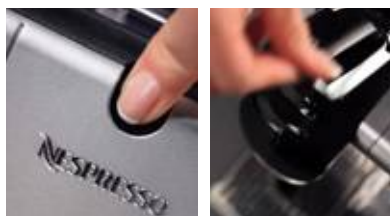

Turn machine on and eject the capsule. Close the lever.

STEP 3



Empty the capsule container and drip tray and place back onto the machine.

STEP 4



Fill the water tank halfway full with water and pour in **1 packet** of descaling solution.

STEP 5



Remove the descaling pipe from its storage door and push it onto the steam connector. The descaling alert will blink orange and the Warm Milk button will shine white.

STEP 6



Place a large receptacle under the coffee outlet and descaling pipe. Press and release the Warm Milk button.

STEP 7

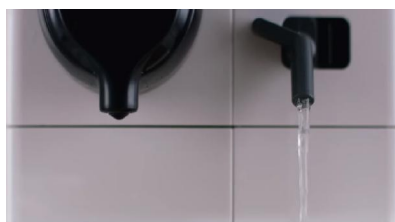

The descaling alert will continue to blink orange and solution will flow out of the coffee outlet and descaling pipe alternately.

STEP 8



Once the tank is empty the Warm Milk button will shine white.

STEP 9

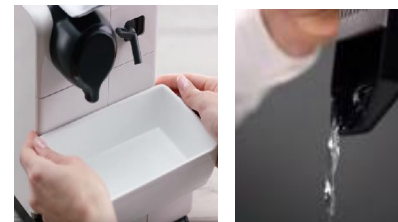

Discard the solution. Empty the drip tray and place back onto the machine.



STEP 10

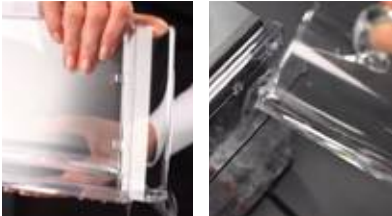

Wash and rinse the water tank thoroughly and refill the tank to the top with fresh water and place on machine.

STEP 11



Put the large receptacle back under the coffee outlet and descaling pipe. Press and release the Warm Milk button.

STEP 12



The descaling alert will blink orange and the rinsing water will flow out of the coffee outlet and descaling pipe alternately.

STEP 13



The machine automatically shuts off when the rinsing is finished. Remove and store the descaling pipe after washing it thoroughly.

STEP 14



Refill the water tank and place it back onto the machine.

STEP 15



Empty and rinse the capsule container and drip tray and reinsert.

STEP 16



Wipe down the machine with a damp cloth. Let the machine rest for 10 minutes. The machine is now ready for use.