



my
machine



Breville

NESPRESSO®

Nespresso is an exclusive system creating the ultimate Espresso, time after time.

All *Nespresso* machines are equipped with a unique extraction system that guarantees up to 19 bar pressure. Each parameter has been calculated with great precision to ensure that all the aromas from each capsule can be extracted, to give the coffee body and create an exceptionally thick and smooth crema.

CONTENT



Please read the instructions and safety precautions before operating the appliance.

Safety precautions	3–4	Troubleshooting	11
Overview	5	Specifications	11
First use	6	Contact the <i>Nespresso</i> Club	11
Coffee preparation	6	Disposal and environmental protection	12
Energy saving mode	7	Warranty	12
Programming the water volume	8		
Emptying the system before a period of non-use and for frost protection, or before a repair	8		
Reset to factory settings	9		
Cleaning	9		
Descaling	9-10		

SAFETY PRECAUTIONS



⚠ CAUTION: the safety precautions are part of the appliance. Read them carefully before using your new appliance for the first time. Keep them in a place where you can find and refer to them later on.

⚠ CAUTION: when you see this sign, please refer to the safety precautions to avoid possible harm and damage.

ℹ INFORMATION: when you see this sign, please take note of the advice for the correct and safe usage of your appliance.

- The appliance is intended to prepare beverages according to these instructions.
- Do not use the appliance for other than its intended use.
- This appliance has been designed

for indoor and non-extreme temperature conditions use only.

- Protect the appliance from direct sunlight effect, prolonged water splash and humidity.
- This appliance is intended to be used in households and similar applications only such as: staff kitchen areas in shops, offices and other working environments, farm houses; by clients in hotels, motels and other residential environments; bed and breakfast type environments.
- This appliance may be used by children of at least 8 years of age, as long as they are supervised and have been given instructions about using the appliance safely and are fully aware of the dangers involved. Cleaning and user maintenance shall not be made by children unless they are older than 8 and they are supervised by an adult.
- Keep the appliance and its cord out of reach of children under 8 years of age.
- This appliance may be used by

persons with reduced physical, sensory or mental capabilities, or whose experience or knowledge is not sufficient, provided they are supervised or have received instruction to use the appliance safely and understand the dangers.

- Children shall not use the device as a toy.
- The manufacturer accepts no responsibility and the guarantee will not apply for any commercial use, inappropriate handling or use of the appliance, any damage resulting from use for other purposes, faulty operation, non-professionals' repair or failure to comply with the instructions.

Avoid risk of fatal electric shock and fire

- In case of an emergency: immediately remove the plug from the power socket.
- Only plug the appliance into suitable, easily accessible, earthed mains connections. Make sure that

the voltage of the power source is the same as that specified on the rating plate. The use of an incorrect connection voids the guarantee.

The appliance must only be connected after installation

- Do not pull the cord over sharp edges, clamp it or allow it to hang down.
- Keep the cord away from heat and damp.
- If the supply cord or the plug are damaged, they must be replaced by the manufacturer, its service agent or similarly qualified persons.
- If the supply cord or the plug are damaged, do not operate the appliance. Only return the appliance to the *Nespresso Club* or to a *Nespresso* authorized representative.
- If an extension cord is required, use only an earthed cord with a conductor cross-section of at least 1.5 mm² or matching input power.
- To avoid hazardous damage, never place the appliance on or beside hot surfaces such as radiators, stoves,

SAFETY PRECAUTIONS

- ovens, gas burners, open flame, or similar.
- Always place it on a horizontal, stable and even surface. The surface must be resistant to heat and fluids, like water, coffee, descaler or similar.
 - The appliance shall not be placed in a cabinet when in use.
 - Disconnect the appliance from the mains when not in use for a long period. Disconnect by pulling out the plug and not by pulling the cord itself or the cord may become damaged.
 - Before cleaning and servicing, remove the plug from the mains socket and let the appliance cool down.
 - Never touch the cord with wet hands.
 - Never immerse the appliance or part of it in water or other liquid.
 - Never put the appliance or part of it in a dishwasher.
 - Electricity and water together is dangerous and can lead to fatal electrical shocks.
 - Do not open the appliance. Hazardous voltage inside!
 - Do not put anything into any openings. Doing so may cause fire or electrical shock!
- Avoid possible harm when operating the appliance**
- Never leave the appliance unattended during operation.
 - Do not use the appliance if it is damaged or not operating perfectly. Immediately remove the plug from the power socket. Contact the *Nespresso Club* or *Nespresso* authorized representative for examination, repair or adjustment.
 - A damaged appliance can cause electrical shocks, burns and fire.
 - Always completely close the lever and never lift it during operation. Scalding may occur.
 - Do not put fingers under coffee outlet, risk of scalding.
 - Do not put fingers into capsule compartment or the capsule shaft. Danger of injury!
 - Water could flow around a capsule when not perforated by the blades and damage the appliance.
 - Never use an already used, damaged or deformed capsule.
 - If a capsule is blocked in the capsule compartment, turn the machine off and unplug it before any operation. Call the *Nespresso Club* or *Nespresso* authorized representative.
 - Always fill the water tank with cold, fresh potable water.
 - Empty water tank if the appliance will not be used for an extended time (holidays, etc.).
 - Replace water in water tank when the appliance is not operated for a weekend or a similar period of time.
 - Do not use the appliance without the drip tray and drip grid to avoid spilling any liquid on surrounding surfaces.
 - Do not use any strong cleaning agent or solvent cleaner. Use a damp cloth and mild cleaning agent to clean the surface of the appliance.
 - To clean machine, use only clean cleaning tools.
 - When unpacking the machine, remove the plastic film and dispose.
 - This appliance is designed for *Nespresso* coffee capsules available exclusively through the *Nespresso Club* or your *Nespresso* authorized representative.
 - All *Nespresso* appliances pass stringent controls. Reliability tests under practical conditions are performed randomly on selected units. This can show traces of any previous use.
 - *Nespresso* reserves the right to change instructions without prior notice.

Descaling

- *Nespresso* descaling agent, when used correctly, helps ensure the proper functioning of your machine over its lifetime and that your coffee experience is as perfect as the first day.

SAVE THESE INSTRUCTIONS
Pass them on to any subsequent user.
This instruction manual is also available as a PDF at [nespresso.com](https://www.nespresso.com)

Packaging content



Coffee machine



Nespresso capsule tasting gift



«Welcome to Nespresso» folder



User manual

- 1 Drip tray
- 2 Drip grid + cup support
- 3 Capsule container for 9 – 11 used capsules
- 4 Coffee outlet
- 5 Lever
- 6 Espresso button (small cup)
- 7 Lungo button (large cup)
- 8 Water tank lid
- 9 Water tank

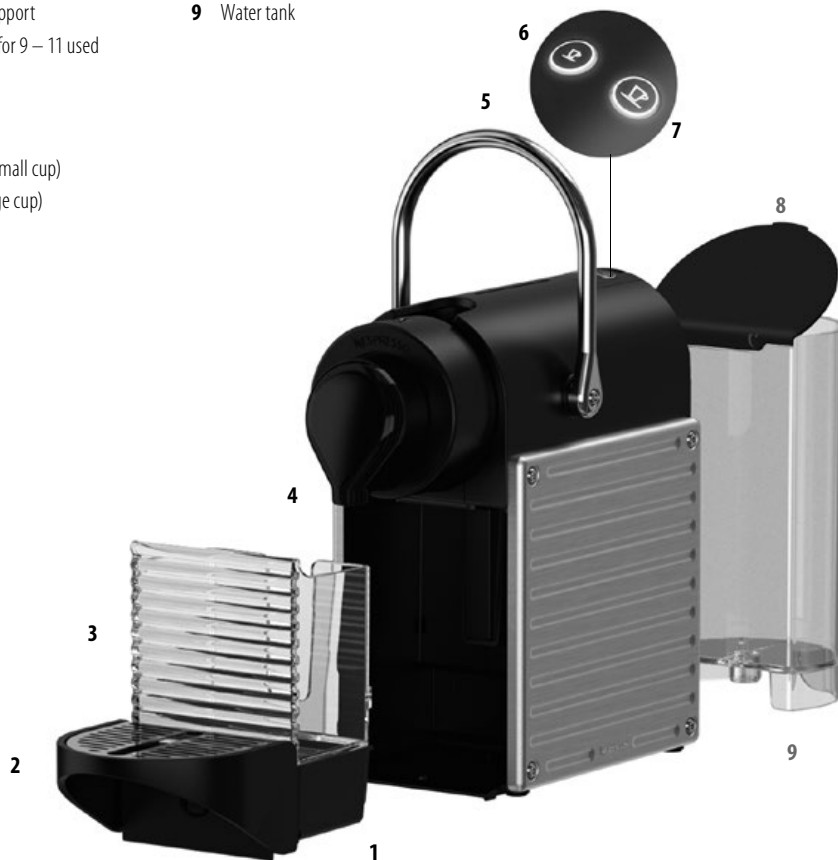

FIRST USE

⚠ First read the safety precautions to avoid risks of fatal electrical shock and fire

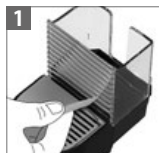

Remove the plastic film from the drip grid.



Remove the water tank and capsule container. Adjust the cable length and store the excess under the machine.



Insert the remaining cable in the cable guide under the machine and put the machine in the upright position.



Plug the machine into the mains.



The water tank can be carried by its cover.



Rinse the water tank before filling with fresh potable water.



To turn the machine On, press either the Espresso or Lungo button. Blinking Lights: heating up
Steady Lights: ready



Place a container under coffee outlet and press the Lungo button to rinse the machine. Repeat three times.

COFFEE PREPARATION



Rinse then fill the water tank with fresh potable water. The water tank can be carried by its cover.



To turn the machine On, press either the Espresso or Lungo button. Blinking Lights: heating up
Steady Lights: ready



Lift the lever completely and insert the capsule.



Close the lever and place a cup under the coffee outlet.

⚠ Never lift lever during operation and refer to the safety precautions to avoid possible harm when operating the appliance



During heat up, you can press the coffee button when it's still blinking. The coffee will then flow automatically when the machine is ready.



For a Latte Macchiato glass fold the cup support into the upright position. It will automatically fall down again when removing the glass to avoid any drips falling on to your kitchen surfaces.



Press the Espresso (40 ml) or the Lungo (110 ml) button. Preparation will stop automatically. To stop the coffee flow or top up your coffee, press again.



Take the cup. Lift and close the lever to eject the capsule into the used capsule container.

ENERGY SAVING MODE

This machine is equipped with an energy saving feature. The machine will automatically enter Auto Off mode after 9 minutes.

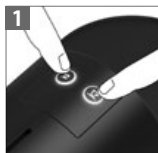

To turn the machine off before automatic Power Off, press both the Espresso and Lungo buttons simultaneously.



With the machine OFF, press and hold the Espresso button for 3 seconds. The Espresso button will blink to indicate the current setting.

To change this setting press the Espresso button:
 One time for Auto Off mode after 30 minutes.
 One more time for Auto Off mode after 9 minutes.
 1x Single blinking: 9 mins mode
 2x Double blinking: 30 mins mode



To exit the energy saving mode press the Lungo button for 3 seconds.

PROGRAMMING THE WATER VOLUME



1 Fill the water tank and insert the capsule.



2 Press and hold the Espresso or Lungo button.



3 Release the button once the desired volume is served.



4 Water volume level is now stored.

EMPTYING THE SYSTEM BEFORE A PERIOD OF NON-USE, FOR FROST PROTECTION OR BEFORE A REPAIR



1 To enter the emptying mode, press both the Espresso and Lungo button to turn the machine off.



2 Remove the water tank. Close the Lever. Place a container under the coffee outlet.



3 Press both the Espresso and Lungo button for 3 seconds. Both LEDs blink alternatively. Wait until no more water comes out.



4 Machine switches off automatically.

RESET TO FACTORY SETTINGS

i Factory settings: Espresso cup: 40 ml, Lungo cup: 110 ml; Auto Off mode: 9 mins.



With machine turned off, press and hold down the Lungo button for 5 seconds.

LEDs will blink fast 3 times to confirm machine has been reset to factory settings.

LEDs will then continue to blink normally, as heating up, until ready.
– Steady Lights: ready

CLEANING

i Do not use any strong cleaning agent or solvent cleaner. Do not put in a dishwasher.

⚠ Never immerse the appliance or part of it in water

Clean the coffee outlet regularly with a damp cloth.



To assemble the cup support and the drip tray: take off the grid, place them side by side and clip the drip tray to the cup support.

DESCALING

www.nespresso.com/descaling

i Duration approximately 15 minutes

⚠ Read the safety precautions on the descaling package and refer to the table for the frequency of use (see page 10)



Remove the capsule and close the lever.



Empty the drip tray and the used capsule container.



Fill the water tank with 0.5 L of water and add the *Nespresso* descaling liquid.



Place a container (minimum volume: 0.6 L) under the coffee outlet.



Switch the machine on.



Blinking light: heating up. Steady light: ready.



Press both coffee buttons simultaneously for three seconds. They will start blinking.



Press the Lungo button and wait until the water tank is empty.



Refill the water tank with the used descaling solution collected in the container and repeat step 8.



Empty and rinse the water tank. Fill it with fresh potable water.



When ready, press the Lungo button to rinse machine. Once the water tank is empty, repeat steps 10 and 11 one more time.

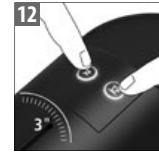

To exit the descaling mode, press both buttons simultaneously for 3 seconds. The machine is now ready for use.

⚠ CAUTION

The descaling solution can be harmful. Avoid contact with eyes, skin and surfaces. The following table will indicate the descaling frequency required for the optimum performance of your machine, based on water hardness. For any additional questions you may have regarding descaling, please contact your *Nespresso Club*.







Water hardness:		Descalce after:		
fH	dH	CaCO ₃	Cups (40ml)	
36	20	360 mg/l	1000	
18	10	180 mg/l	2000	
0	0	0 mg/l	4000	

fh French grade
 dh German grade
 CaCO₃ calcium carbonate

TROUBLESHOOTING

No light.	→ The machine has switched off automatically; turn the machine on. → Check the mains: plug, voltage, fuse.
No coffee, no water.	→ Check the water tank, if empty, fill with fresh potable water. Descale it if necessary. → Lift the lever. Press one coffee button and wait until water comes out.
Coffee is not hot enough.	→ Preheat cup. Descale the machine if necessary.
The lever cannot be closed completely.	→ Empty the capsule container/Check that there is not a capsule blocked inside the machine.
Leakage or unusual coffee flow.	→ Check that the water tank is in position.
Lights flash irregularly.	→ Call the <i>Nespresso</i> Club. → Exit descaling procedure (see paragraph on descaling).
No coffee, water just comes out (despite inserted capsule).	→ In case of difficulties, call the <i>Nespresso</i> Club.
Machine switches itself off.	→ To save energy the machine will turn itself off after 9 minutes of non use. See paragraph on «Energy saving mode».

SPECIFICATIONS

	220-240 V, 50-60 Hz, < 1260 W
P _{max}	19 bar
	~ 3 kg
	0.7 L
	 11.1 cm  23.5 cm  32.6 cm

CONTACT THE NESPRESSO CLUB

For any additional information, in case of problems or simply to seek advice, call the *Nespresso* Club. Contact details of the *Nespresso* Club can be found in the «Welcome to *Nespresso*» folder in your machine box or at nespresso.com

DISPOSAL AND ENVIRONMENTAL PROTECTION

This appliance complies with the EU Directive 2012/19/EC. Packaging materials and appliance contain recyclable materials.

Your appliance contains valuable materials that can be recovered or can be recycled. Separation of the remaining waste materials into different types facilitates the recycling of valuable raw materials. Leave the appliance at a collection point. You can obtain information on disposal from your local authorities. To know more about Nespresso sustainability strategy, go to www.nespresso.com/positive

WARRANTY

Breville guarantees this product against defects in materials and workmanship for two years domestic use (or 3 months commercial use) from the date of purchase. During this period, Breville will either repair or replace, at its discretion, any defective product at no charge to the consumer. In the event of a product or accessory being repaired or replaced during the guarantee period, the guarantee on the repaired product will expire two years from the purchase date of the original product, not two years from the date of repair. This guarantee excludes liability for consequential loss or any other loss or damage caused to property or person arising from any cause whatsoever. It also excludes defects caused by the product not being used in accordance with instructions, accidental damage, misuse, being tampered with by unauthorised persons, improper maintenance, consumable items or normal wear and tear and does not cover the cost of claiming under the warranty. Except to the extent applicable by law, the terms of this warranty do not exclude, restrict or modify, and are in addition to, the mandatory statutory rights applicable to the sale of the product to you.

How to Claim Under the Breville Warranty

Nespresso is handling product enquiries and product servicing on Breville's behalf. If you believe your product is defective, contact the *Nespresso* customer service team directly for instructions on where to send or bring it for repair by a Breville authorised service agent. Contact *Nespresso* Australia: 1800 623 033 or New Zealand: 0800 234 579 auclub@nespresso.com

This product is imported and distributed by Breville and this warranty is provided by Breville. To the extent permitted by law, *Nespresso* has no liability for the product and all guarantees, warranties and conditions by *Nespresso* are excluded.

Breville



BEC430
by *Nespresso*