



## VERTUO POP



NESPRESSO

## CLICK AND CHOOSE YOUR LANGUAGE

**EN**

---



**SAFETY**



**OVERVIEW**



**CONNECTIVITY**



**FIRST STEPS**



**COFFEE PREPARATION**



**ADAPT YOUR COFFEE VOLUME**



**CLEANING**



**DESCALING**



**EMPTYING THE SYSTEM**



**RESET TO FACTORY SETTINGS**



**BLINKING SUMMARY**



**TROUBLESHOOTING**



**SPECIFICATIONS**

## SAFETY

**CAUTION:** Before operating your coffee machine, please refer to the **safety instructions leaflet** to avoid possible harm and damage.

### TIPS FOR USING YOUR VERTUO MACHINE

1. Please avoid stopping or opening the machine while it is in operation.
2. Frequent rinsing with hot water may accelerate wear on the machine. It is recommended to do a rinsing cycle after 100 coffees.
3. After brewing, kindly open the machine and remove the capsule from the brewing unit. This practice helps prevent coffee buildup and ensures smooth flow through the needle.

### DISPOSAL AND ENVIRONMENTAL PROTECTION

This appliance complies with the EU Directive 2012/19/EC. Packaging materials and appliance contain recyclable materials. Your appliance contains valuable materials that can be recovered or can be recycled. Separation of the remaining waste materials into different types facilitates the recycling of valuable raw materials. Leave the appliance at a collection point. You can obtain information on disposal from your local authorities.



## OVERVIEW

### MACHINE OVERVIEW

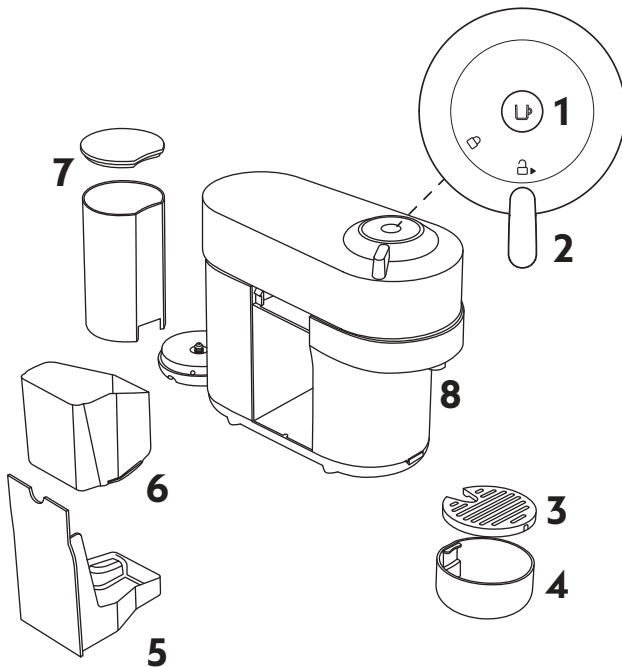

- 1** ON/OFF and coffee button
- 2** Locking/Unlocking lever
- 3** Drip Grid
- 4** Adjustable cup support
- 5** Drip Tray
- 6** Container for used capsules
- 7** Water Tank and lid
- 8** Coffee outlet

### PACKAGING CONTENT



- 1** Coffee Machine
- 2** **Nespresso** capsules box
- 3** **Nespresso** welcome material
- 4** Safety Instructions
- 5** Quick Start Guide
- 6** Warranty

**i Unboxing:** some dust may be present on the surface of the machine due to the recycled materials used in the packaging. This is not dangerous, simply clean with a soft tissue.

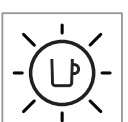
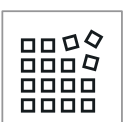



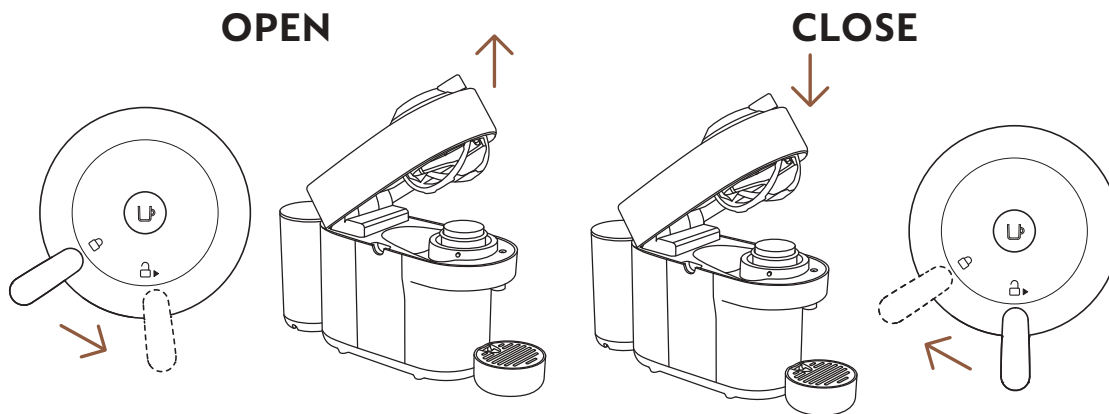

## OPEN/CLOSE



**CAUTION:** for proper machine usage, please do not open the machine head while the coffee is brewing, wait until the coffee button goes back to steady white. If you want to stop the brewing earlier, please press once on the coffee button and wait until the machine stops before opening the machine head.

## THE VERTUO SYSTEM

### CAPSULE COMPATIBILITY

			
<b>S</b>	<b>M</b>	<b>L</b>	<b>XL</b>
<b>Ristretto</b>	<b>Double Espresso</b>	<b>Mug</b>	<b>Alto, Cold Brew Style</b>
(25 ml / 0.84 fl oz.)	(80 ml / 2.7 fl oz.)	(230 ml / 7.77 fl oz.)	(355 ml / 12.5 fl oz.)
<b>Espresso</b>	<b>Gran Lungo</b>		<b>Carafe</b>
(40 ml / 1.35 fl oz.)	(150 ml / 5.07 fl oz.)		(535 ml / 18 fl oz.)

### ACCESSORY COMPATIBILITY



Not suitable  
accessories



**Mug (L)** **Carafe**

Discover our full accessory collection on [www.nespresso.com](http://www.nespresso.com)

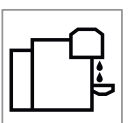
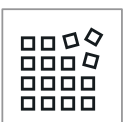

## ON/OFF

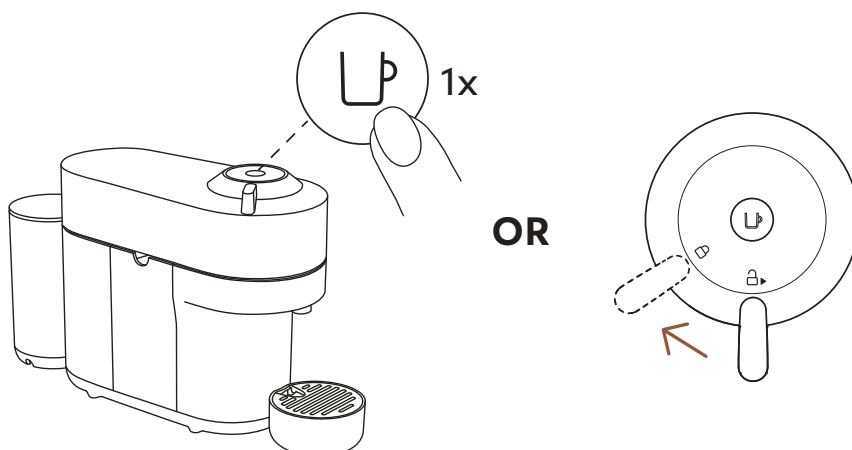
**ON**

Once the machine is plugged in, turn on by pressing once on the button or by closing the lever in the lock position (with the head closed).

- i** The light will blink for approximately 30 seconds while the machine is heating up. Once the light is steady, the machine is ready to be used.

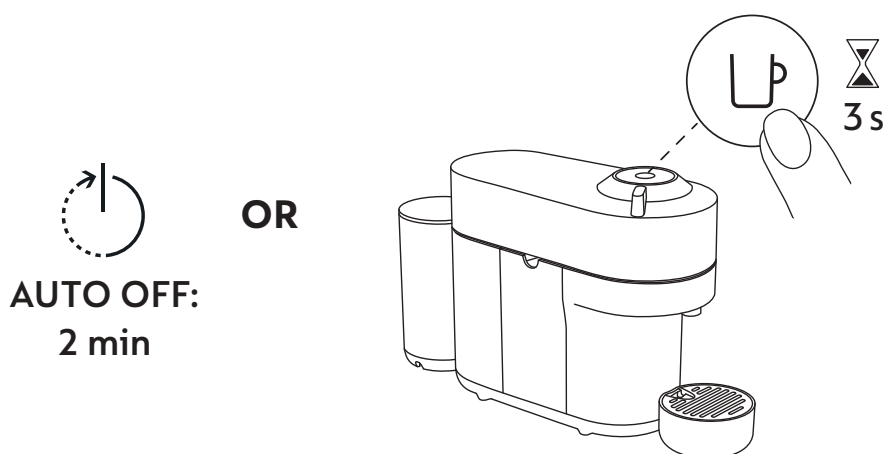
**OFF**

To save energy the machine will turn off after 2 minutes of non-use.

- i** The machine can be turned “OFF” manually at any time (when not in use) by pressing and holding the button for 3 seconds.

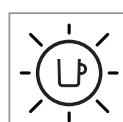
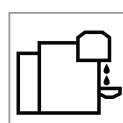
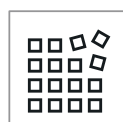
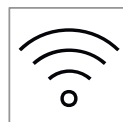



## CONNECTIVITY

### WHY SHOULD YOU PAIR YOUR VERTUO POP MACHINE?

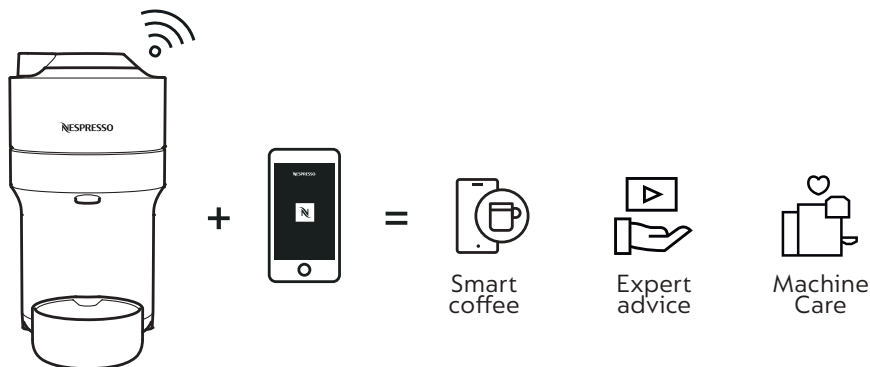

### BENEFITS OF CONNECTING YOUR VERTUO POP MACHINE

- **Smart coffee:** Always stay one step ahead to get the latest on our coffee innovations from **Nespresso** by keeping your machine up to date
- **Expert advice:** Get support and simple tutorial videos to accompany your coffee journey via your smartphone
- **Machine Care:** Receive instant notification on how and when to service your machine with an easy-step guide on descaling, rinsing, cleaning, etc.

### HOW TO CONNECT YOUR VERTUO POP MACHINE?

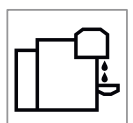



- 1 Download or update the **Nespresso** App. Launch the **Nespresso** App on your smartphone or your tablet. Press the machine icon at the top right of your screen.

**NOTE:** for optimal performance and a seamless experience, we recommend connecting your machine to a Wi-Fi router rather than using a smartphone hotspot.

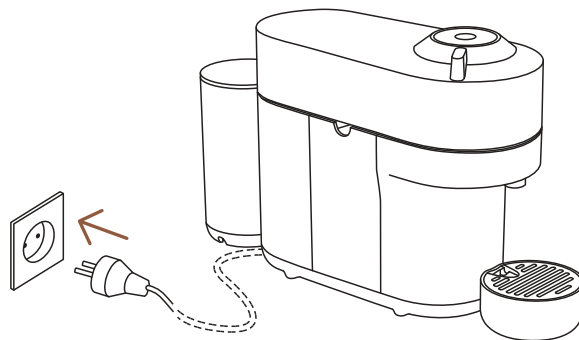

- 2 Plug the power chord.

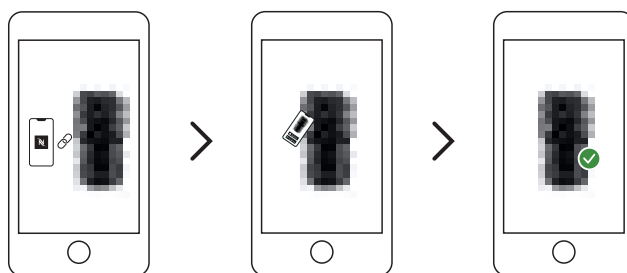

- 3 Follow the instructions via the **Nespresso** App.

**CAUTION:** First read the safety precautions to avoid risks of fatal electrical shock and fire. Please ensure ground continuity when plugging the machine in the power outlet.

\* App Store® is a trademark of Apple Inc., registered in the U.S. and other countries.

\*\* Google Play and the Google Play logo are trademarks of Google LLC.

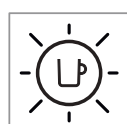
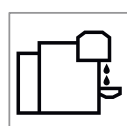
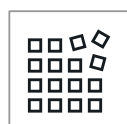



## DISABLING MACHINE BLUETOOTH AND WI-FI

The machine comes with a connectivity module, enabled by default. It gives access to additional features, enhancing your coffee experience. To disable the connectivity module, follow these steps:

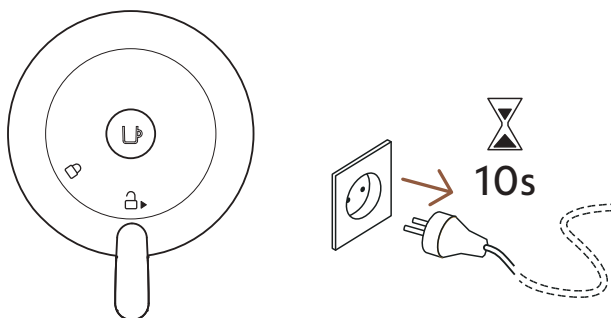

- 1 With the machine closed and the lever in **unlocked** position, unplug the machine for at least 10 seconds.

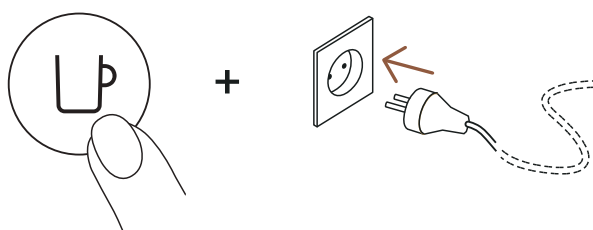

- 2 Press and hold the button while plugging  
The button will blink orange to confirm that the connectivity module has now been disabled.
- i** Follow the same steps to set the connectivity module back on again. The button will blink white to confirm that the module has been reactivated.

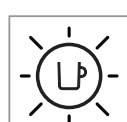
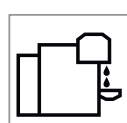
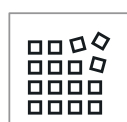

# FIRST STEPS

## FIRST RINSING

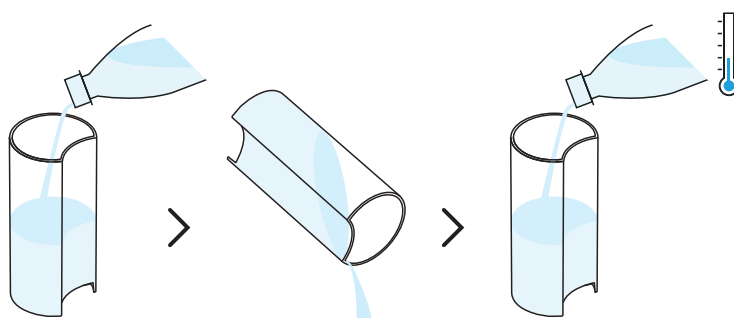

- 1** First rinse and clean the water tank and lid before filling it with fresh drinking water.

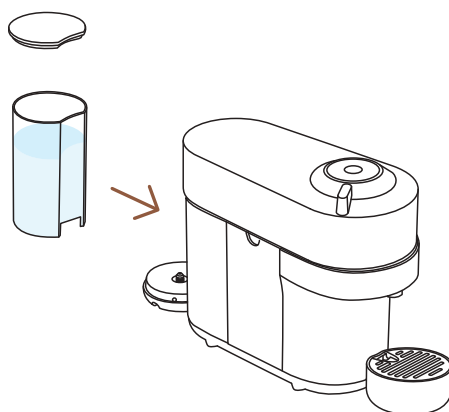

- 2** Close the water tank with the lid and put the water tank in place and make sure it is properly attached.

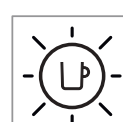
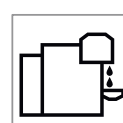
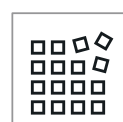
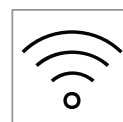

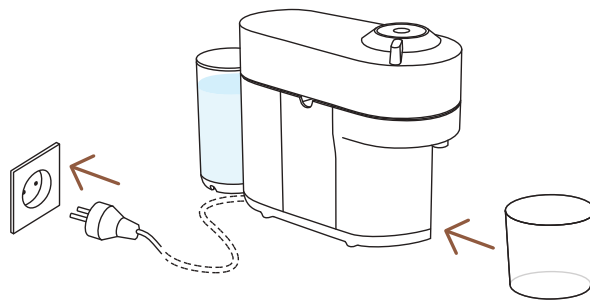

- 3** With the machine plugged, remove the cup support and place an empty container (of at least 1 L / 34 fl oz.) under the coffee outlet.

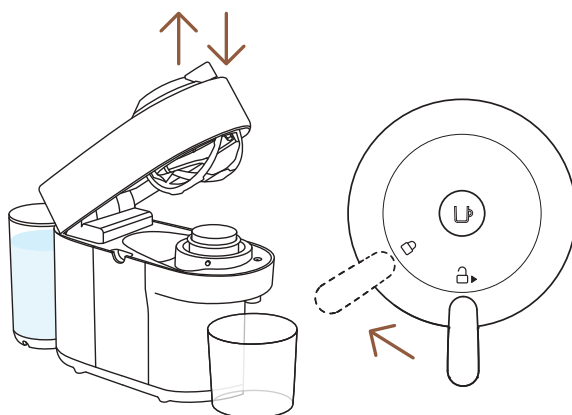

- 4** Open and close the machine. Ensure the lever is in lock position.

- i** The light will blink while the machine is heating up. It will take approximately 30 seconds. When the light becomes steady the machine is ready. Make sure that no capsule is inserted.

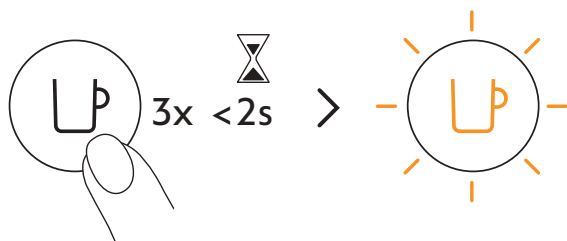

- 5** Press the button 3 times within 2 seconds to start rinsing. With the light blinking orange, let the rinsing procedure complete automatically. When the light becomes steady white, the cycle is complete.

- i** It should take less than 2 minutes before the rinsing process begins and water starts to flow. This procedure may take up to 7 minutes.

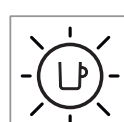
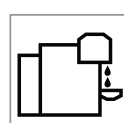
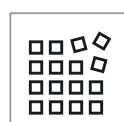
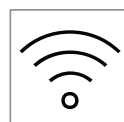

# COFFEE PREPARATION

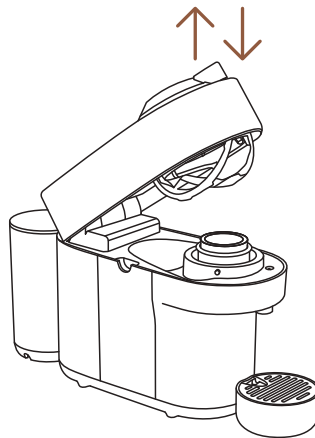

**1** Open and close the machine.

**i** The coffee button light will blink while the machine is heating up. When the light becomes steady, the machine is ready to use.

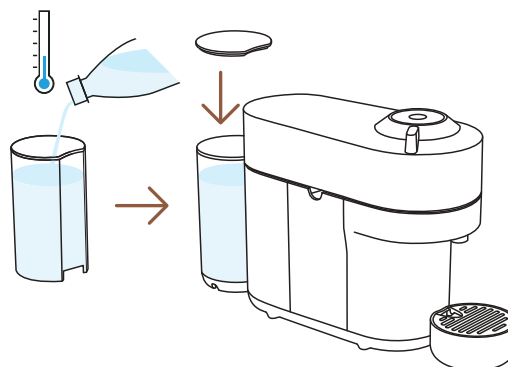

**2** Fill the water tank with fresh drinking water and put it back in position.



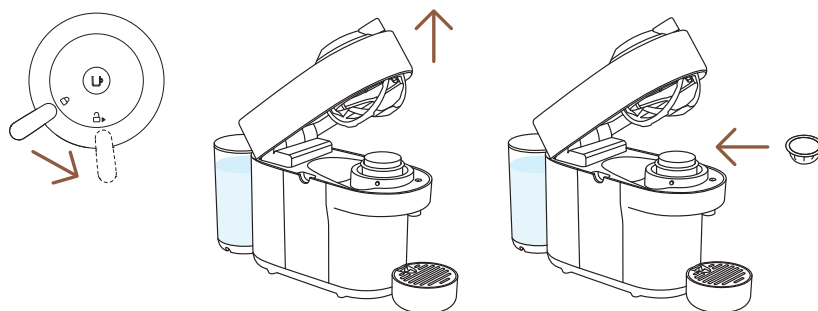

- 3** Unlock and open the machine head completely and insert a Vertuo capsule with the dome shape facing down.

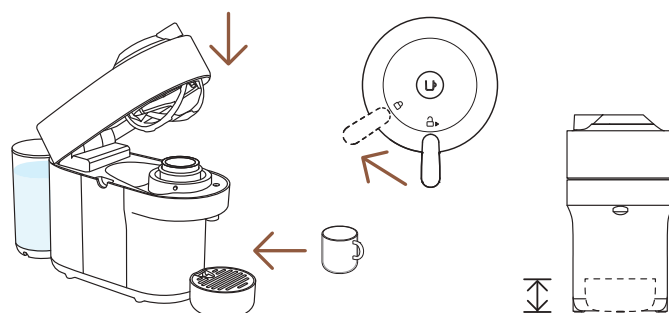

- 4** Close the machine head and lock by turning the lever left until the lock position and place a cup. The cup support can be adjusted to accommodate your cup size.

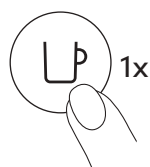

- 5** Start brewing by pressing the button once.

**CAUTION:** for proper machine usage, please do not open the machine head while the coffee is brewing, wait until the coffee button goes back to steady white. If you want to stop the brewing earlier, please press once on the coffee button and wait until the machine stops before opening the machine head.

- i** Due to the code reading, coffee pre-wetting and infusion time, it will take a moment before the coffee begins to flow. The machine will automatically recognize the inserted capsule and select the coffee preparation parameters and cup length defined by **Nespresso** coffee experts to extract the coffee blends at it's best.

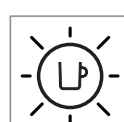
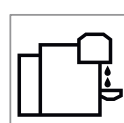
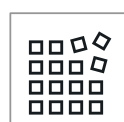
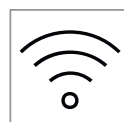

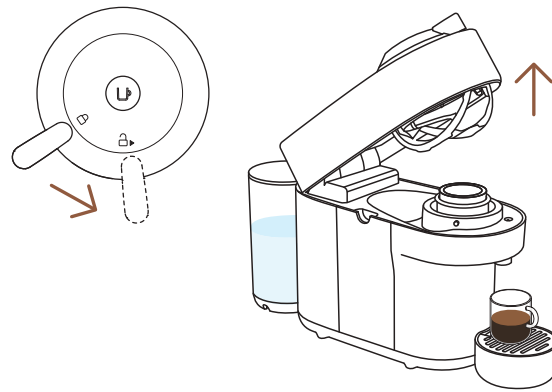

- 6** When the coffee stops brewing, open the machine head by turning the lever right towards the unlock position to automatically eject the capsule and enjoy your coffee.

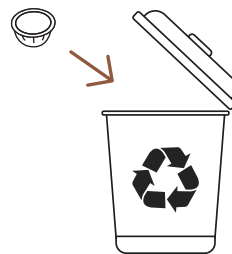

- 7** Don't forget to recycle your **Nespresso** capsules.\*

\* THIS IS **NESPRESSO**. THIS IS RECYCLABLE. For more information about recycling your **Nespresso** capsules, visit [www.nespresso.com](http://www.nespresso.com)

### DISCOVER OUR COFFEE CREATIONS MODE



With this machine, **Nespresso** offers you a specific function to concentrate your coffee extractions to create your own recipes.

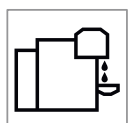



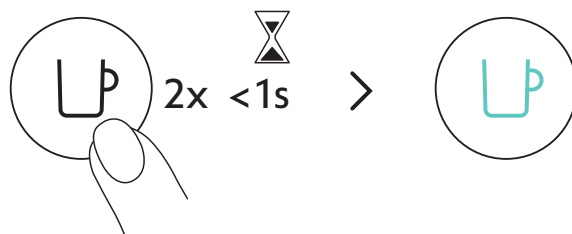

With your machine on, double click on the coffee button. It will blink turquoise and your coffee brew will be concentrated, optimizing the coffee taste in recipes with add-ons (milk, creamer, over ice...). For Incomparable Coffee Experience.

40 ml / 1.35 fl oz	80 ml / 2.7 fl oz	150 ml / 5.07 fl oz	230 ml / 7.77 fl oz	355 ml / 12 fl oz	535 ml / 18.8 fl oz
✓	✓	✓	✓	✗	✗
25 ml / 0.85 fl oz	40 ml / 1.35 fl oz	40 ml / 1.35 fl oz	80 ml / 2.7 fl oz		

To fully enjoy the benefits, we recommend brewing our Coffee+ range using only the official cup sizes. For the best in-cup results, we do not recommend brewing our XL (Alto Ambrato, Alto Onice), Cold Brew Style & Carafe Pour Over Style with this mode.

**NOTE:** An update of your machine via the **Nespresso** App may be necessary to enable this mode.



Discover how to upgrade your machine with our Aeroccino range on [www.nespresso.com](http://www.nespresso.com)

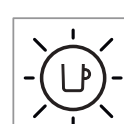
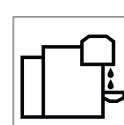
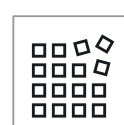
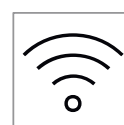

## ADAPT YOUR COFFEE VOLUMES

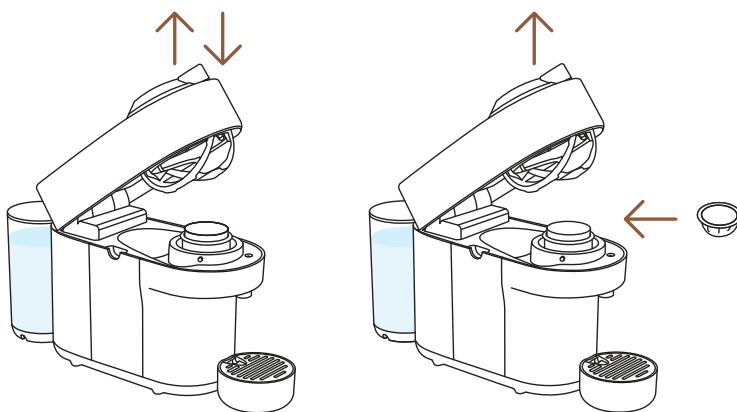

- 1 Open and close the machine. With the machine on, open the machine and insert the capsule you want to program.

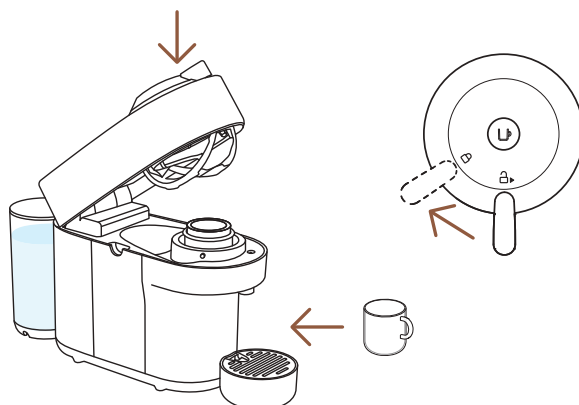

- 2 Close the machine head, turn the lever left towards the lock position and place a cup.

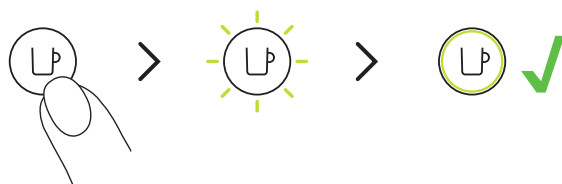

- 3 Press and hold the button, letting go a few seconds before the desired volume is reached. The new water volume is now programmed for the capsule type used during the setting.

**i** The programming is specific to each capsule type Cup sizes may be programmed from 20 ml / 0.68 fl oz. to 535 ml / 18 fl oz.

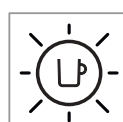
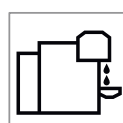
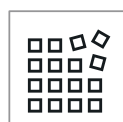
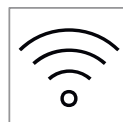

**CAUTION:** for proper machine usage, please do not open the machine head while the coffee is brewing, wait until the coffee button goes back to steady white. If you want to stop the brewing earlier, please press once on the coffee button and wait until the machine stops before opening the machine head.

**NOTE:** Once a customer-specific volume is programmed by the user, every time that capsule type is inserted in the machine, the preparation will stop at the user-programmed cup size. If you wish to come back to the default parameters see the paragraph **“Reset to factory settings”**.

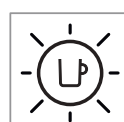
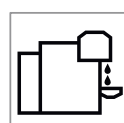
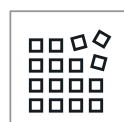
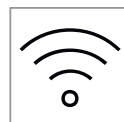

## CLEANING

Clean your machine on a monthly basis, when you start having coffee residue inside the machine head or after a long period of non-use.

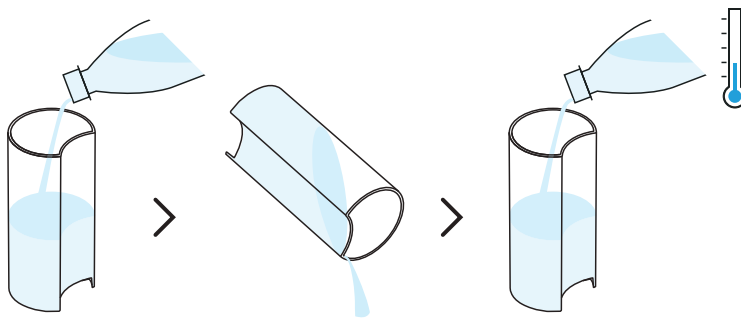

- 1** Rinse and clean the water tank and the lid before filling it with fresh drinking water.

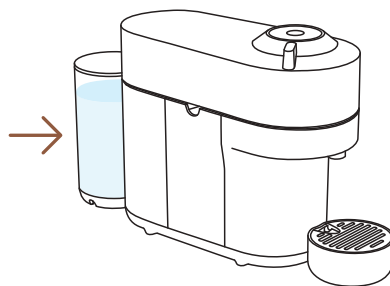

- 2** Put the water tank back in position on the machine.



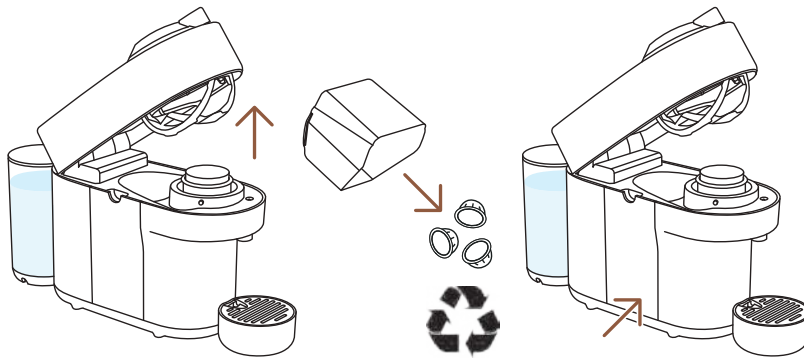

- 3** With machine on, unlock and open the machine and let the used capsule be ejected. Empty and rinse the capsule container and the drip tray and put them back in place. Don't forget to recycle your **Nespresso** capsules.\*

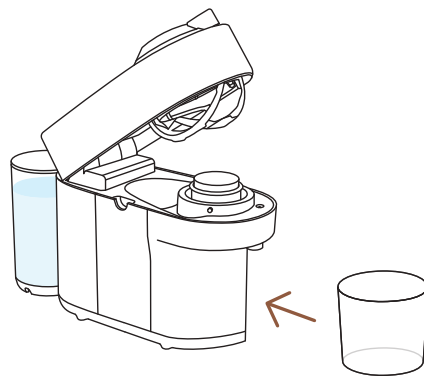

- 4** Remove the cup support and place an empty container (of at least 1 L / 34 fl oz.) under the coffee outlet.

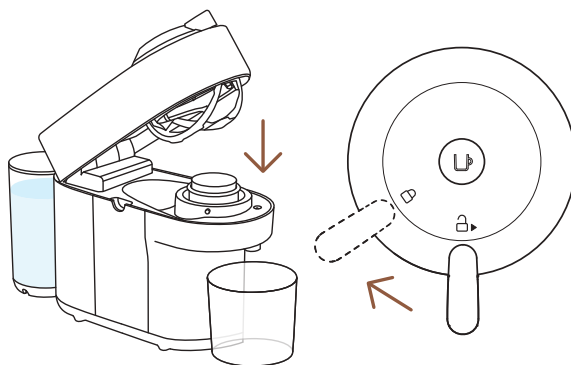

- 5** Close the machine head and turn the lever left towards lock position. Make sure no capsules are present in the machine before starting the rinsing procedure.

\* THIS IS **NESPRESSO**. THIS IS RECYCLABLE. For more information about recycling your **Nespresso** capsules, visit [www.nespresso.com](http://www.nespresso.com)



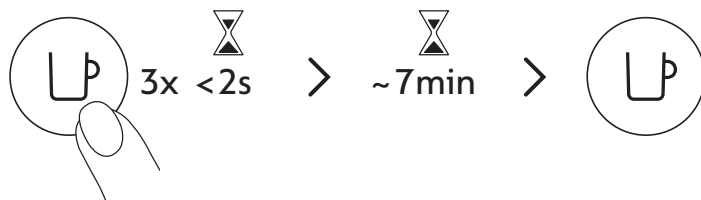

- 6** Press the button 3 times within 2 seconds to start rinsing. With the light blinking orange, let the rinsing procedure complete automatically.

- i** It should take less than 2 minutes before the rinsing process begins and water starts to flow. This operation may take up to 7 minutes and will stop automatically when the cycle is complete. the procedure can be stopped at any time by pressing the button.

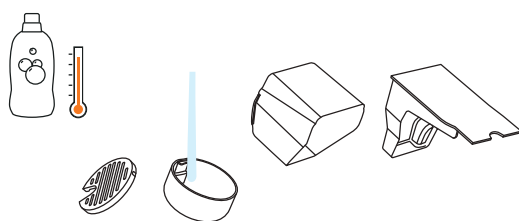

- 7** Wash the capsule container, the cup support and the drip tray with hot water and mild odorless detergent.

**CAUTION:** Do not use any strong or abrasive cleaning agent or solvent cleaner. Do not put the machine in a dishwasher. Never immerse the appliance or part of it in water.

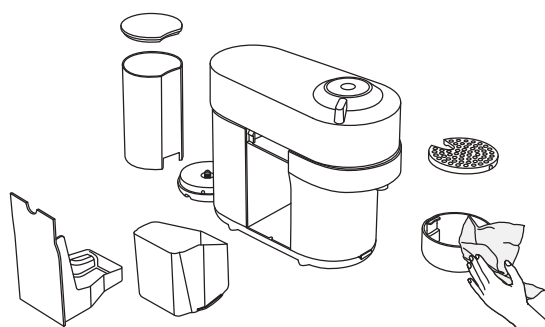

- 8** Dry with a clean and fresh towel

**CAUTION:** Clean the coffee outlet regularly with a clean damp cloth. Always use soft cloths to clean the machine.

**NOTE:** Water may accumulate inside the machine's head, please dry visible parts with a clean dry cloth.

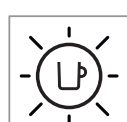
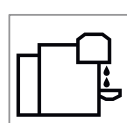
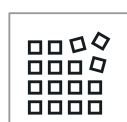
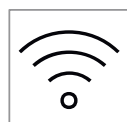



## DESCALING

Descaling your machine will ensure that it functions properly throughout its lifetime and will make your coffee experience as incomparable as it was the first day. Your machine will indicate when descaling is needed by blinking orange 3 times before steady white.



**i** The descaling procedure takes ~20 minutes and **cannot be interrupted**.

**NOTE:** Please carefully read the descaling instructions before starting.

### You will need:

- A descaling kit available on [www.nespresso.com](http://www.nespresso.com)
- An empty container (1L / 34 fl oz.)

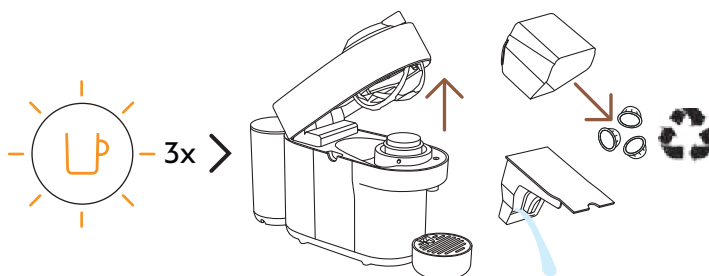

- 1** With the button blinking orange 3 times: Unlock and open the machine head and let the used capsule be ejected. Empty the capsule container and the drip tray and place them back in position on the machine. Don't forget to recycle your **Nespresso** capsules.\*

\* THIS IS **NESPRESSO**. THIS IS RECYCLABLE. For more information about recycling your **Nespresso** capsules, visit [www.nespresso.com](http://www.nespresso.com)

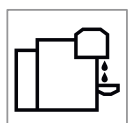
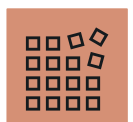

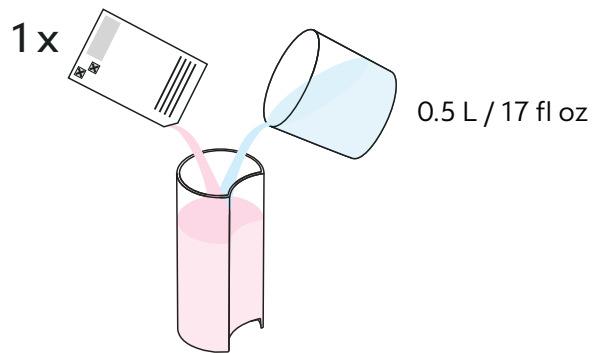

- 2** Fill the water tank with 0.5 L / 17 fl oz. of water and add 1 unit of **Nespresso** descaling liquid.

**CAUTION:** Please note that the descaling solution can be harmful. Avoid contact with eyes, skin and surfaces.

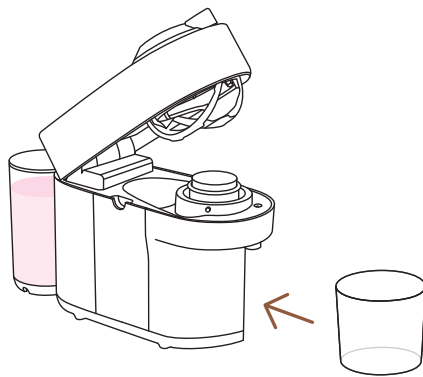

- 3** Remove the cup support and place an empty container (of at least 1 L / 34 fl oz.) under the coffee outlet.

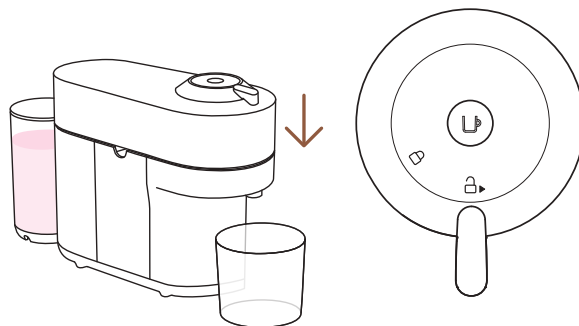

- 4** With machine on, close the machine head and leave the lever in unlock position.

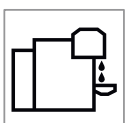
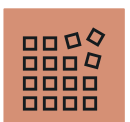

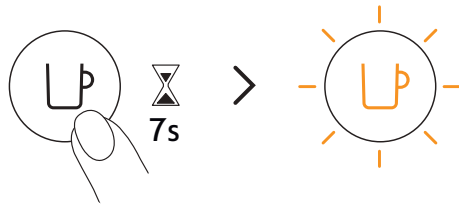

- 5** Hold the button for at least 7 seconds or until you see the light turn off. The button will start blinking orange rapidly.

**CAUTION:** You now have 45 seconds to enter the descaling mode, otherwise the machine will return to the brewing mode.

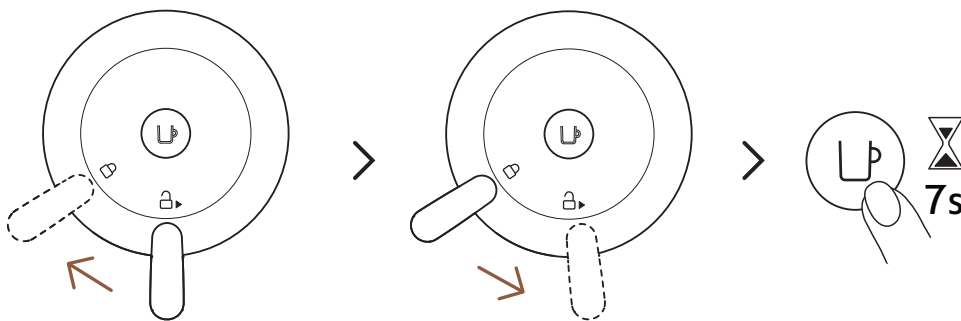

- 6** Lock the machine head by turning the lever left until the lock symbol and then unlock the lever by turning right to the unlock position. Press and hold the button again for approximately 7 seconds or until the light turns off. The button will start blinking orange rapidly.

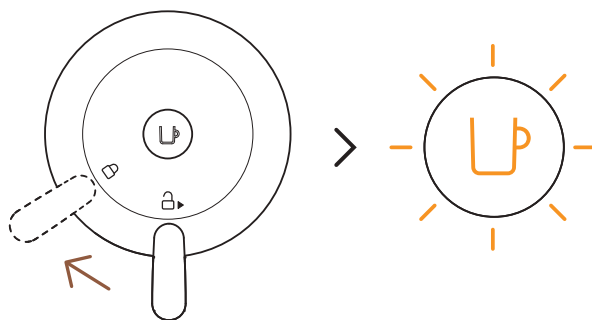

- 7** To enter the descaling mode, lock the machine by turning the lever left towards the lock position. The light should still be blinking orange quickly. This is an indication that you have entered descaling mode.

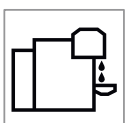
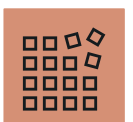

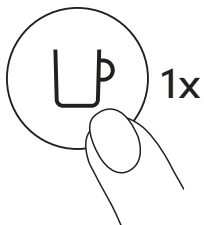

- 8** Press the coffee button once to begin the descaling process. The light will continuously blink orange throughout the process.

- i** The machine will stop automatically when the first phase of descaling is completed.

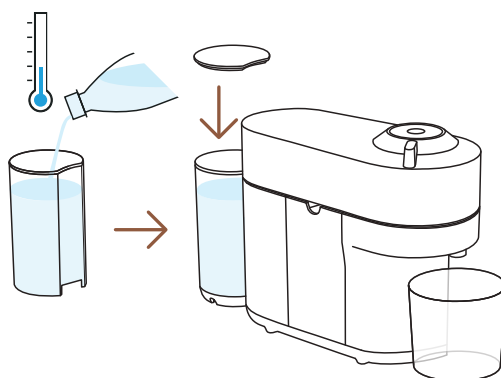

- 9** At the end of the descaling process, it is time to rinse the machine. Rinse the water tank and drip tray thoroughly. Fill the water tank with fresh drinking water and put it back in place. Empty the container and place it back under the coffee outlet.

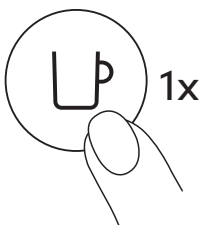

- 10** Press the button to rinse the machine. When the button stops blinking rapidly, the descaling procedure is completed.

- i** The machine will stop automatically when the procedure is completed.

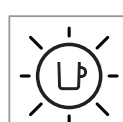
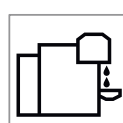
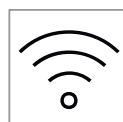

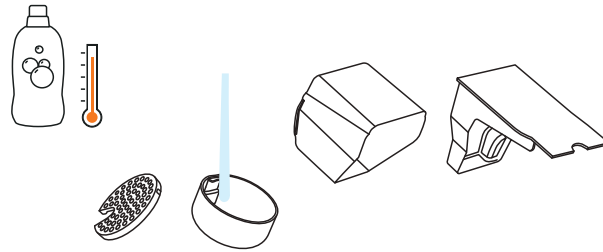

- 11** Wash the capsule container, the cup support and the drip tray with hot water and mild odorless detergent.

**CAUTION:** Do not use any strong or abrasive cleaning agent or solvent cleaner. Do not put the machine in a dishwasher. Never immerse the appliance or part of it in water.

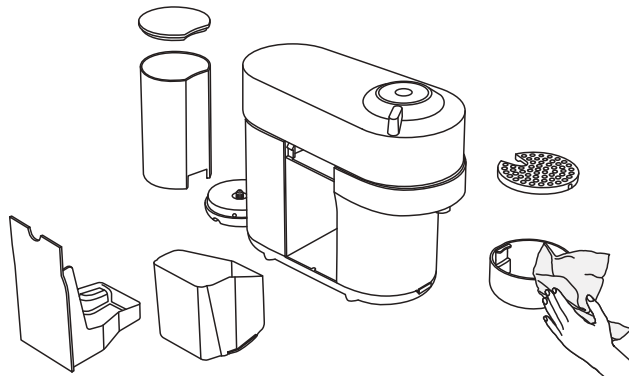

- 12** Dry the machine with a clean and fresh towel. Let the machine dry for 10 minutes before using it.

**NOTE:** Water may accumulate inside the machine's head during cleaning. If this happens, please dry visible parts with a clean dry cloth.

**NOTE:** the machine can only enter descaling mode after 30 or more coffees have been brewed

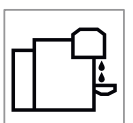

## EMPTYING THE SYSTEM

Emptying the system is a process that could be done before a period of non-use, for frost protection or prior to sending the machine for a repair.

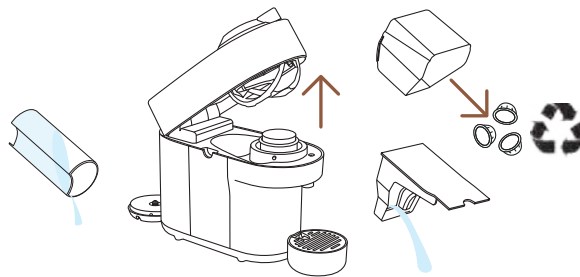

- 1 Empty the water tank, open the machine head, and let the used capsule be ejected. Empty the capsule container and the drip tray. Don't forget to recycle your **Nespresso** capsules.\*

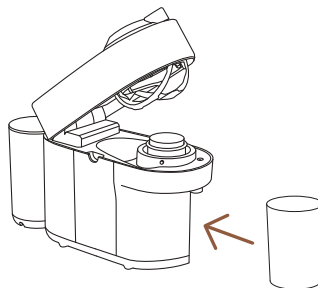

- 2 Place them back in position on the machine, remove the cup support and place an empty container (0.5 L / 17 fl oz.) under the coffee outlet.

\* THIS IS **NESPRESSO**. THIS IS RECYCLABLE. For more information about recycling your **Nespresso** capsules, visit [www.nespresso.com](http://www.nespresso.com)





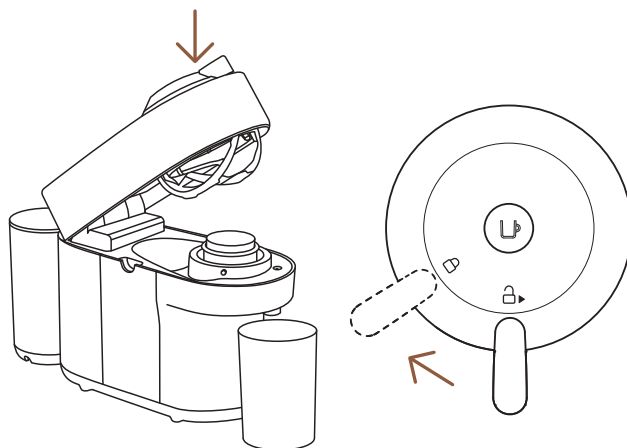

- 3** With machine plugged and on, turn the lever towards the lock position.

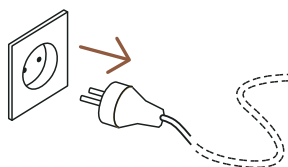

- 4** Unplug the machine

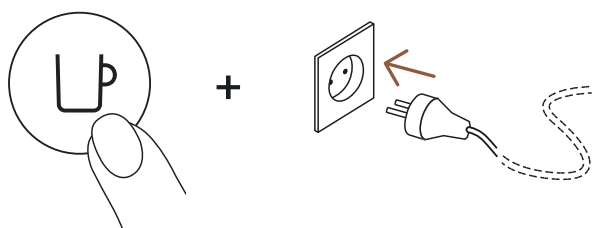

- 5** Press and hold the button while plugging the machine.

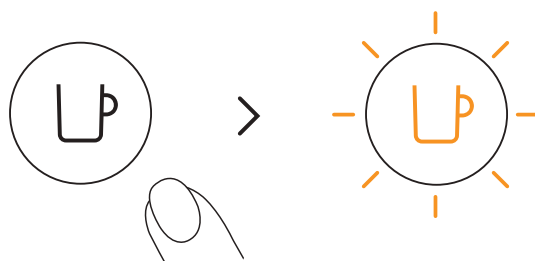

- 6** Release the button. It will blink orange and the emptying process will start.

- i** It will take approximatively 30 seconds for the machine to complete the emptying process. The machine turns off automatically when it is empty.

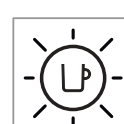
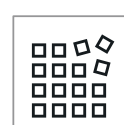
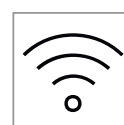

## RESET TO FACTORY SETTINGS

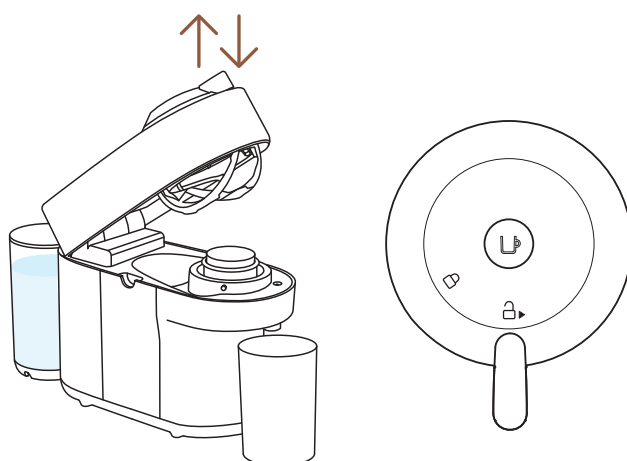

- 1 With the machine plugged, open then close the machine head before leaving the lever on the **unlock** position.

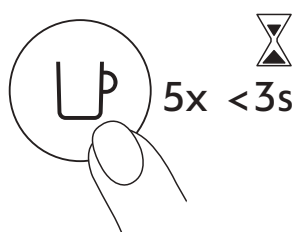

- 2 Press the button 5 times within 3 seconds. The machine is now programmed with the factory settings.

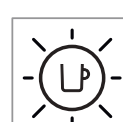
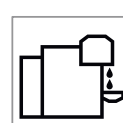
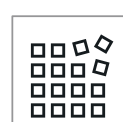
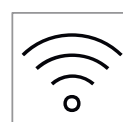

## BLINKING SUMMARY

You want to learn more about the Vertuo Pop blinkings?  
Please watch the following video:

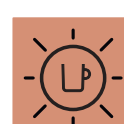
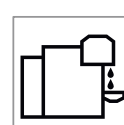
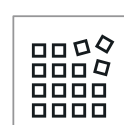
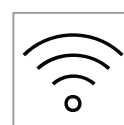

## TROUBLESHOOTING

### No light on the button

- The machine has turned OFF automatically; push the button or “UNLOCK” the machine.
- Check the mains, plug, voltage, and fuse.

### No coffee, no water.

- Check that the water tank is filled.
- Check that a fresh capsule is inserted in correct position, that the lever is properly locked and push the button to start.
- Descale if necessary.
- Open the machine head and let the capsule be ejected. Then perform a cleaning as per cleaning section.

### Coffee is not hot enough.

- Preheat cup with hot drinking water from the tap.
- Descale if necessary.

### Leakage or unusual coffee flow.

- Check that the water tank is well positioned.
- Descale if necessary.

### Machine turns to “OFF mode”

- To save energy the machine will turn off after 2 minutes of non-use.
- The machine can be turned “OFF” manually at any time (when not in use) by pressing and holding the button for 3 seconds.

### Coffee grounds in the cup.

- Perform the cleaning procedure twice.
- See paragraph on **“Cleaning”**.

### The machine doesn't start and has light steady on. If blinking, see next points.

- Check that lever is properly locked.
- If you want to brew a Coffee or Espresso, check that a fresh capsule is inserted in correct position, that the lever is properly locked and push the button to start.
- If you are cleaning, descaling or emptying the system, check that no capsule is inserted then close, lock the machine and push the button to start one of these operations.

### The machine doesn't start and light blinks alternately; 1 blink and 1 pause.

- Fill the water tank and push button to start.
- Check that lever is properly locked.

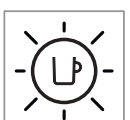

### Light blinks while machine is running

- If coffee is flowing normally, this indicates the machine is working properly.
- If only water is flowing, the machine is executing a user request for either cleaning, descaling or emptying the system. Please refer to the corresponding chapter
- Turn the machine to “OFF mode” by pushing the button for 3 seconds and then push it again to turn the machine ON. Now wait approximately 20 minutes to allow the machine to cool down after extensive use.

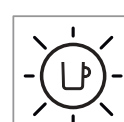
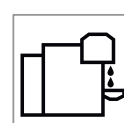
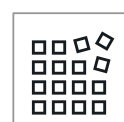
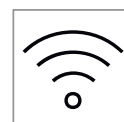

### Light blinks and machine is not running.

- It will take some time before the coffee flow comes out (due to barcode reading and pre-wetting the coffee).
- Check that a fresh capsule is inserted in correct position, that the lever is properly locked and push the button to start.
- Fill the water tank and press the button to start.
- Turn the machine to “OFF mode” by pushing the button for 3 seconds and then push it again to turn the machine ON. Now wait approximately 20 minutes to allow the machine to cool down after extensive use.

### Light blinks alternately 2 blinks and 1 pause continuously. Machine is not running.

- During regular Coffee/Espresso preparation:
  - 1) Unlock the lever and open the machine head to check that a fresh undamaged capsule is inserted in the correct position.
  - 2) Check that the lever is in “LOCKED” position.
  - 3) Check that the water tank is filled.
- During Descaling, Emptying and Cleaning:
  - 1) Check that capsule is ejected.
  - 2) Check that the lever is in “LOCKED” position.
- During Programming Volume:
  - 1) Check if a capsule has been well inserted.
  - 2) Please refer to the corresponding chapter

**Light alternately  
blinking 3 times and  
then steady on.**

- If problem persists:
  - 1) Unlock the lever and open machine head
  - 2) Replace capsule (if needed).
  - 3) Disconnect powercord from the outlet and plug the machine back into outlet after 10 seconds.
  - 4) Close the head and press the button to turn ON and press again to start brewing. If problem persists, call **Nespresso**.
- Descaling needed: the machine can be used only a few times after the descaling alert appears before it becomes necessary.

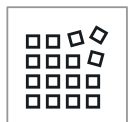



## SPECIFICATIONS

<b>Power</b>	<b>~220–240 V, 50–60 Hz, 1300–1500 W</b> <b>US, CA:</b> 120 V, 60 Hz, 1500 W <b>MX:</b> 127 V~, 60 Hz, 1 650 W
<b>Frequency</b>	2.402–2.480 GHz
<b>RF Output power (EIRP)</b>	Bluetooth 4 dBm Max. e.i.r.p. and Wi-Fi <20 dMm max. e.i.r.p.
<b>Standby</b>	0.39 W
<b>Power saving mode</b>	Auto off: 2 min
<b>Heat-up time</b>	30 seconds (head closed and locked)
<b>Movable cup support for large recipes</b>	Removable single position
<b>Cable length from device connection</b>	75 cm / 30 in
<b>Dimensions (W x D x H)</b>	13.6 x 42.6 x 25 cm / 5.3 x 16.7 x 9.8 in
<b>Weight</b>	3.5 kg / 7.72 lbs
<b>Water tank capacity</b>	600 ml / 20 fl oz
<b>Capsule container capacity</b>	8 espresso or 5 mug capsules

## MACHINE CODES

<b>Nespresso</b>	<b>Breville</b>	<b>Delonghi</b>
GCV2, GDV2	BNV120, BNV150	ENV90
<b>Krups</b>	<b>Magimix</b>	
XN9201, XN9204, XN9205, XN9211	M800	

